

| | | |
|------|-------------|-----------|
| REV. | DESCRIPTION | DATE |
| A | NEW DRAWING | 2/24/2006 |

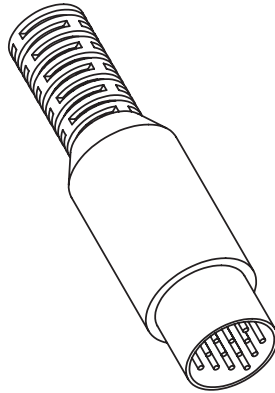

TOLERANCE:
X.X ± 0.1 mm
X.XX ± 0.05 mm

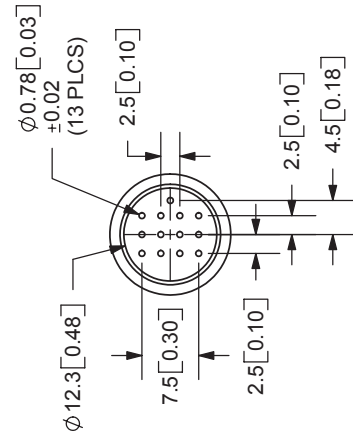
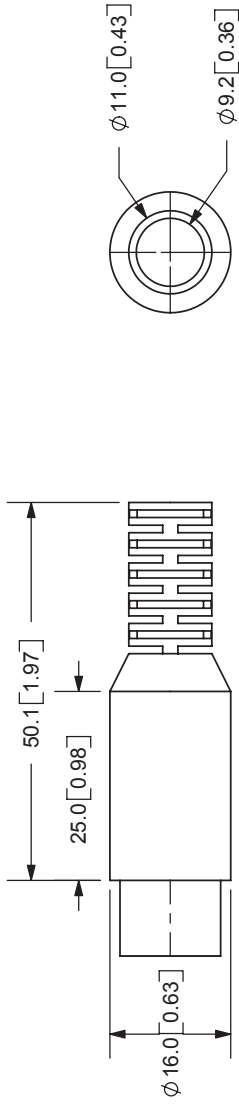

9615 SW Allen Blvd., Ste. 103
Beaverton, OR 97005
Phone: 503-643-4899
800-275-4899
Fax: 503-372-1266
Website: www.cui.com

SPECIFICATIONS:
RATING: 100V DC @ 1A
CONTACT RESISTANCE: Pins-30m OHMS MAX; Shell-50m OHMS MAX
INSULATION RESISTANCE: 100M OHMS MIN; 500V DC
VOLTAGE WITHSTAND: 1000A AC R.M.S. FOR 1 MINUTE
LIFE: 5,000 CYCLES
OPERATING TEMP: -5° ~ +110°C

| | | | |
|-----------|--------------|--------------|-------------|
| TITLE: | IN-LINE PLUG | REV: | A |
| PART NO: | SD-130 | UNITS: | MM [INCHES] |
| DRAWN BY: | ZRJ | APPROVED BY: | |
| | | SCALE: | 1:1 |

| | MATERIAL | PLATING |
|-----------|----------|---------|
| PINS | Brass | Silver |
| SHELL | Steel | Nickel |
| INSULATOR | PBT | |
| BOOT | PVC | |

PC FILE NAME: SD-130

COPYRIGHT 2006 BY CUI INC.