



Part No: GC0401MP

Date: 7/03/2007

Unit: mm

Description: speaker

Page No: 1 of 2

Specifications

| | | |
|----------------------|--|--|
| Nominal Size | 40 mm | 1 ½ inch. |
| Impedance | 8 Ohm ± 15% | at 0.8 KHz 1 V |
| Resonant frequency | 600 Hz ± 120 Hz | at 1 V |
| Sound pressure level | 80 dB/w ± 3 dB | 0.2 w 50 cm ave at 1K, 1.5K, 1.8K, 2K Hz |
| Response | Fo Hz ~ 8 KHz max 10 dB | |
| Input power | Nominal 0.2 W | Handling capacity 0.5 W |
| Operation | must be normal at program source 0.2 W | |
| Buzz, rattle, etc. | must be normal at sine wave 1.26 V | |
| Magnet | Size: 12.5 x 1.5 mm | |
| Load test | White noise 0.2 W | for 5 hours |
| Heat test | 65 ± 2° C | 20-50% R.H. 24 hours |
| Humidity test | 40 ± 2° C | 90-95% R.H. 24 hours |

Frequency Response Curve

| | |
|-----------------------|------------|
| Potentiometer range | 50 dB |
| Rectifier | RMS |
| Lower limit frequency | 20 Hz |
| Wr. speed | 100 mm/sec |

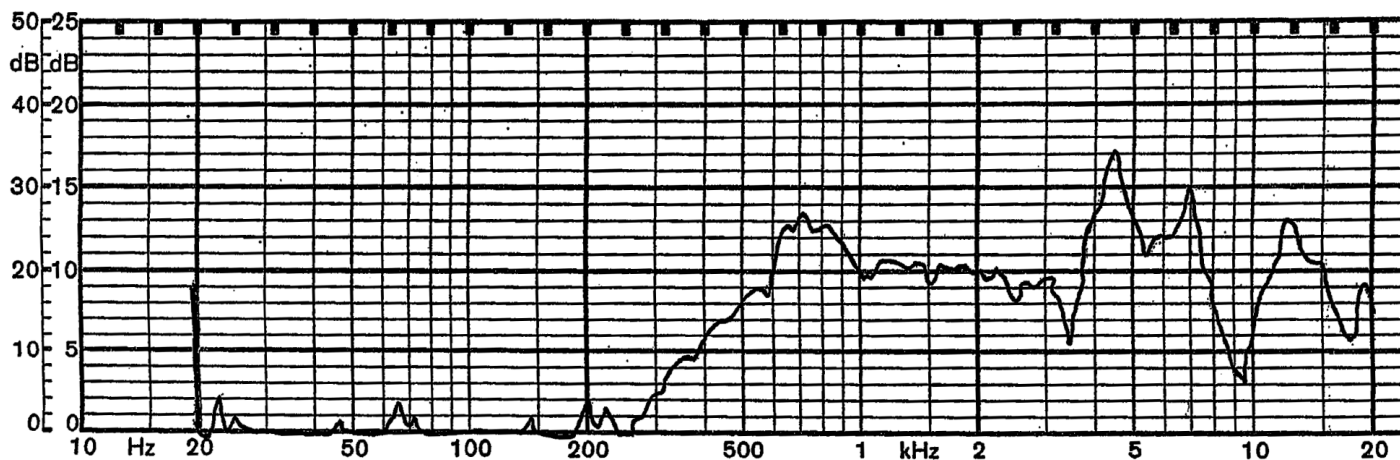

Zero level 60 dB

| | | |
|------|-------------|----------|
| REV. | DESCRIPTION | DATE |
| A | NEW DRAWING | 7/3/2007 |

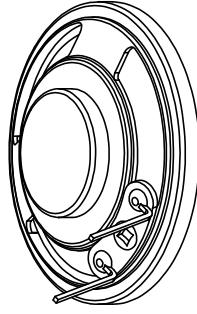
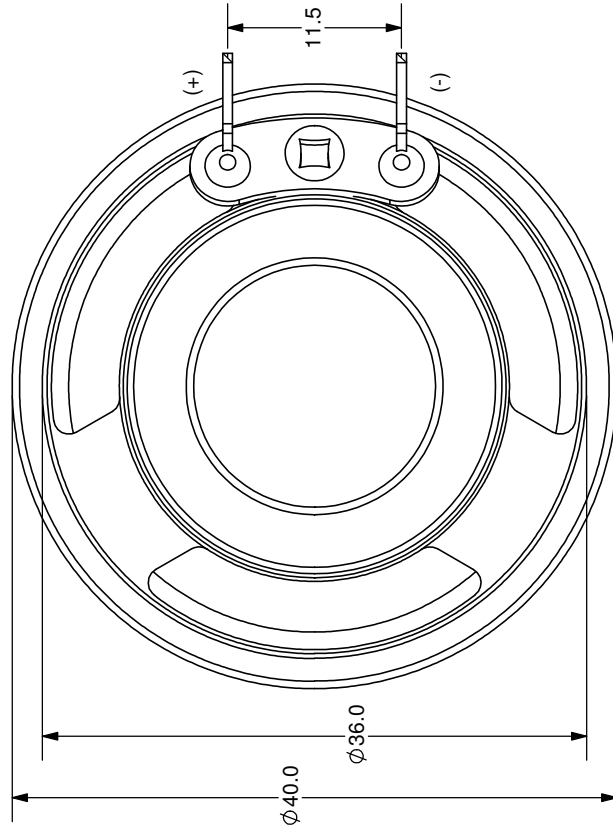
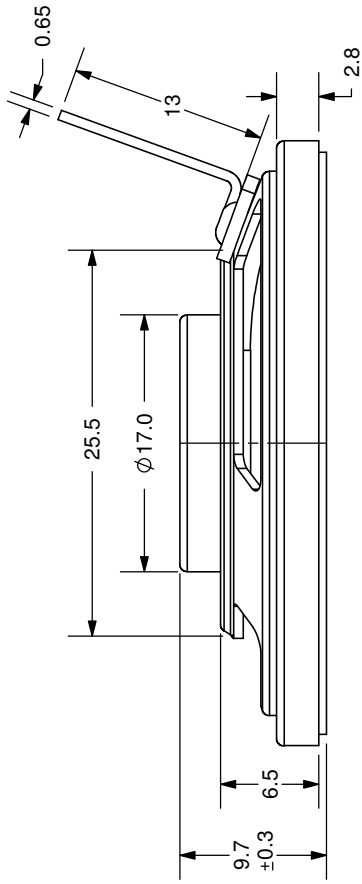

SCALE 1:1



TOLERANCE:
±0.3mm UNLESS OTHERWISE
SPECIFIED



CUI INC

20050 SW 112th Ave.
Tualatin, OR 97062
Phone: 503-612-2300
800-275-4899
Fax: 503-612-2383
Website: www.cui.com

| | |
|----------------------------|--------------------|
| TITLE: LOW PROFILE SPEAKER | REV: A |
| PART NO: CLS0401MP | UNITS: MM [INCHES] |
| DRAWN BY: ZRJ | APPROVED BY: |
| | SCALE: 2:1 |