

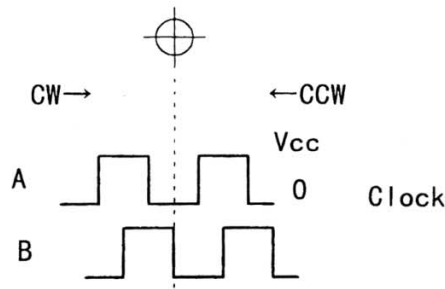

9615 SW Allen, Suite 103
 Beaverton, OR 97005
 Phone: (503) 643-4899
 800-275-4899
 Fax: (503) 372-1266
 Website: www.cui.com

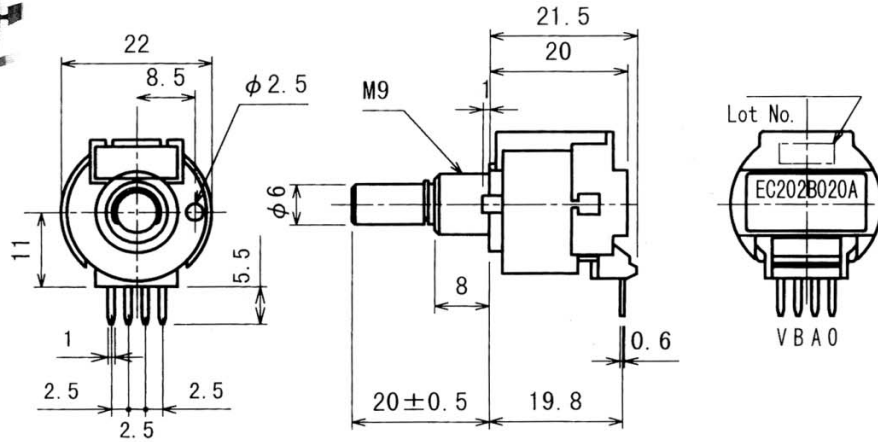
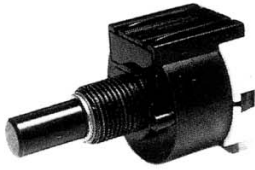

Output wave

Detent position

● Specifications

Supply Voltage	DC5V \pm 5%	Resolution	20P/R
Supply Current	30mA Max.	Frequency Response	100Hz
Output	Incremental	Rotational Life	2,000,000
Phase Difference	90 \pm 45°	Operational Torque	40 \pm 20gcm
Output Wave	Rectangle Wave	Click	With Click
Operating Temperature Range	0 ~ +60°C	Weight (Approx.)	28g
Storage Temperature Range	-20 ~ +80°C		

PART NO.	EC202B020A	UNITS:	mm
TOLERANCE:	± 0.5	PAGE NO:	1 of 1