

REV.	DESCRIPTION	DATE
A	NEW DRAWING	12/1/2008

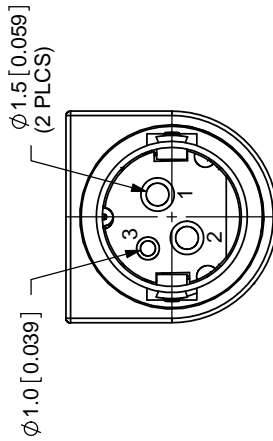
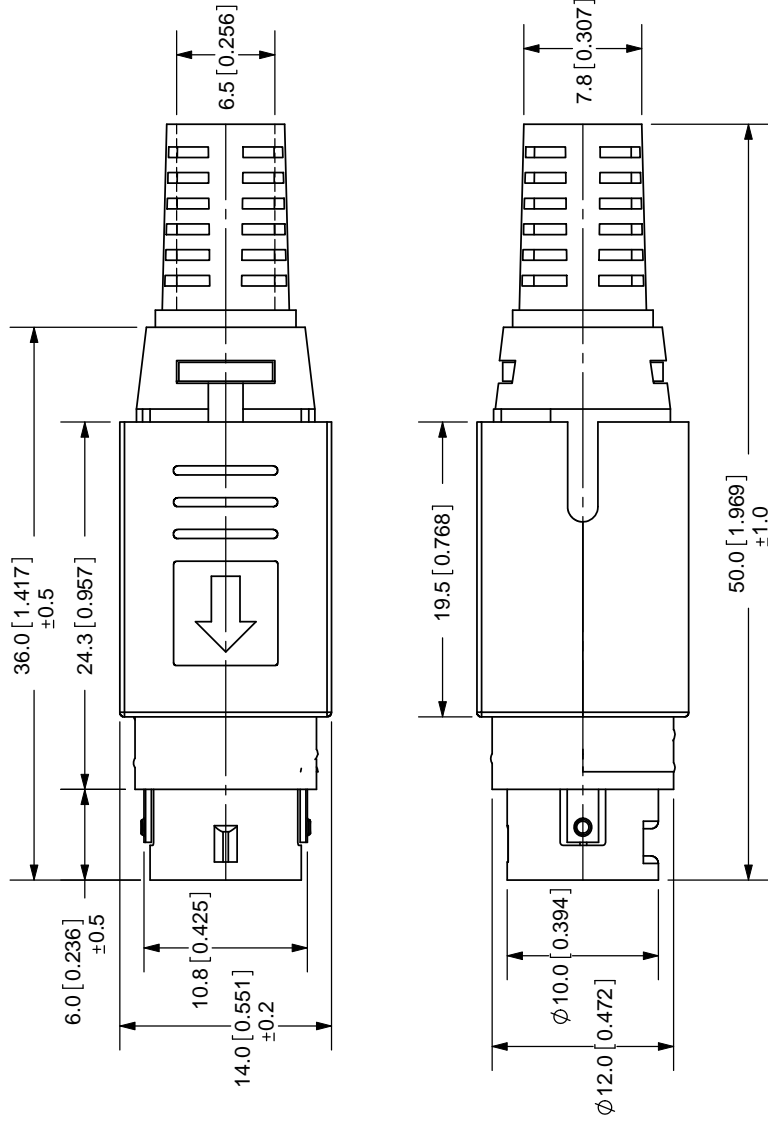

TOLERANCE:  
±0.2mm UNLESS OTHERWISE  
SPECIFIED

SPECIFICATIONS:  
RATING: PINS 1&2: 20V DC @ 7.5A  
PIN 3: 20V DC @ 1A  
INSULATION RESISTANCE: 50M OHMS MIN: 250V DC  
VOLTAGE WITHSTAND: 250V AC R.M.S. FOR 1 MINUTE  
LIFE: 5,000 CYCLES

MATERIAL	PLATING
OUTER HOOD	ABS
METAL SLEEVE	Brass
CLAMP	Brass
PIN/BODY	Brass/PBT
PLASTIC RING	POM
METAL COVER	Brass
SPRING	Steel
INNER HOOD	ABS
STRAIN RELIEF	PVC







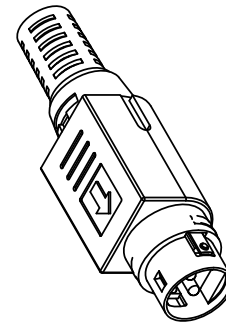

20050 SW 112th Ave.  
Tualatin, OR 97062  
Phone: 503-612-2300  
800-275-4899  
Fax: 503-612-2383  
Website: www.cui.com

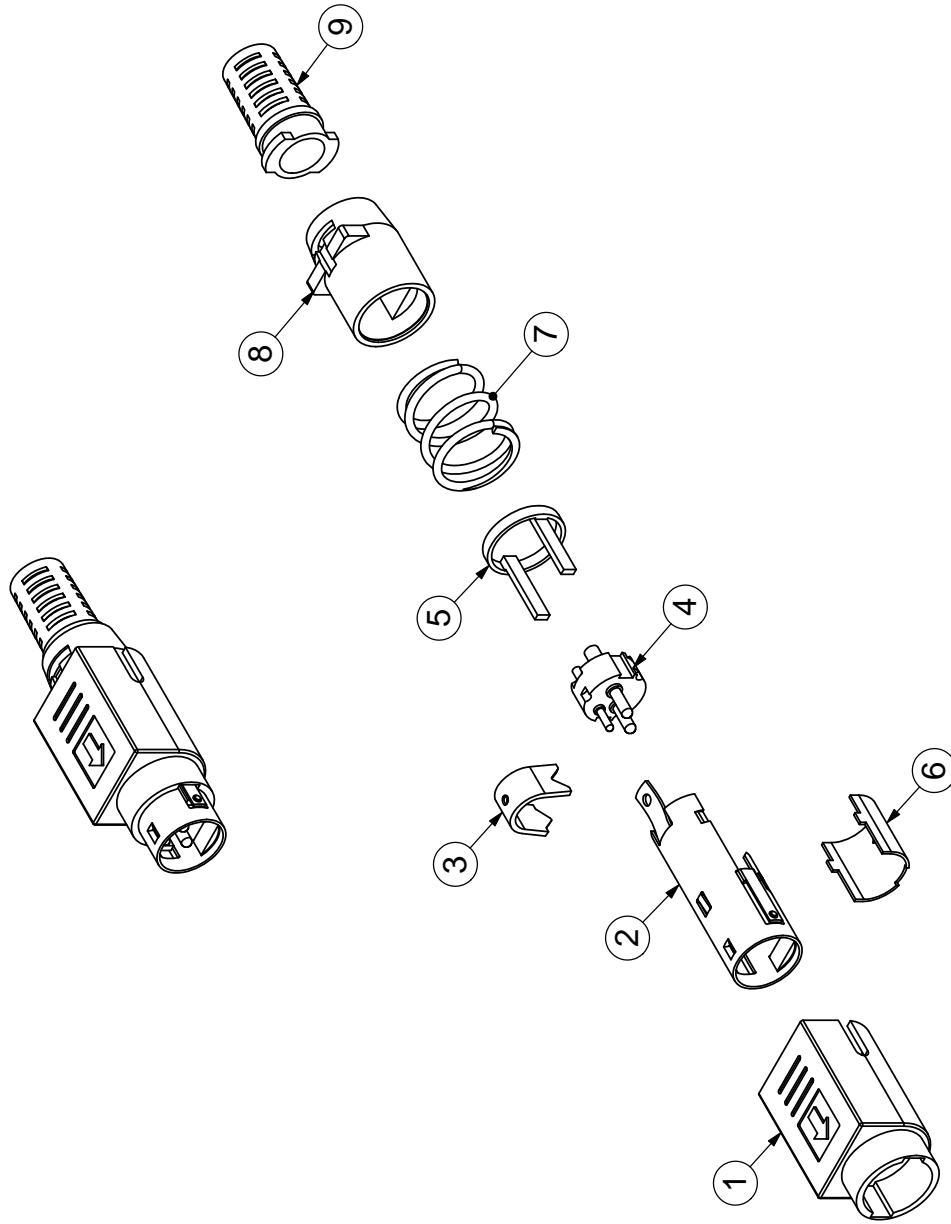
TITLE:	3-PIN POWER DIN PLUG	REV:	A
PART NO:	PDP-30	UNITS:	MM [INCHES]
DRAWN BY:	ZRJ	APPROVED BY:	
		SCALE:	2:1

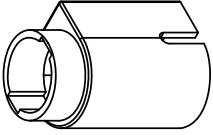
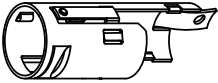

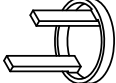
SCALE: 1:2

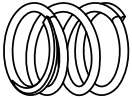
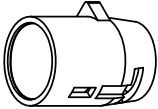
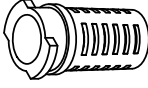

				
1 outer hood	2 metal sleeve	3 clamp	4 pin body	5 plastic ring
				
6 metal cover	7 spring	8 inner hood	9 strain relief	9 strain relief

TITLE: 3-PIN POWER DIN PLUG	REV: A
PART NO: PDP-30	UNITS: MM [INCHES]
DRAWN BY: ZRJ	APPROVED BY:
SCALE: 1:1	

**STEP 1**

insert strain relief (9), inner hood (8), and spring (7) onto cable

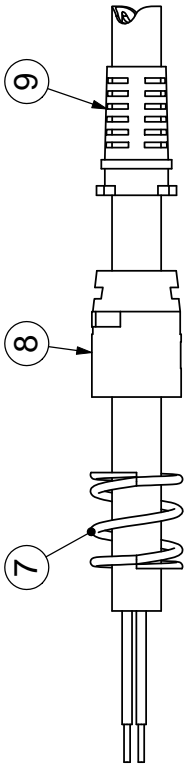

**STEP 2**

solder wires to contacts on pin body (4)

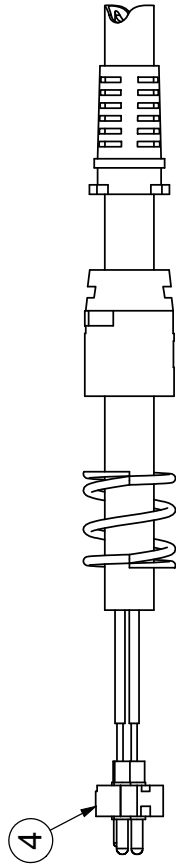

**STEP 3**

push pin body (4) and plastic ring (5) into metal sleeve (2)

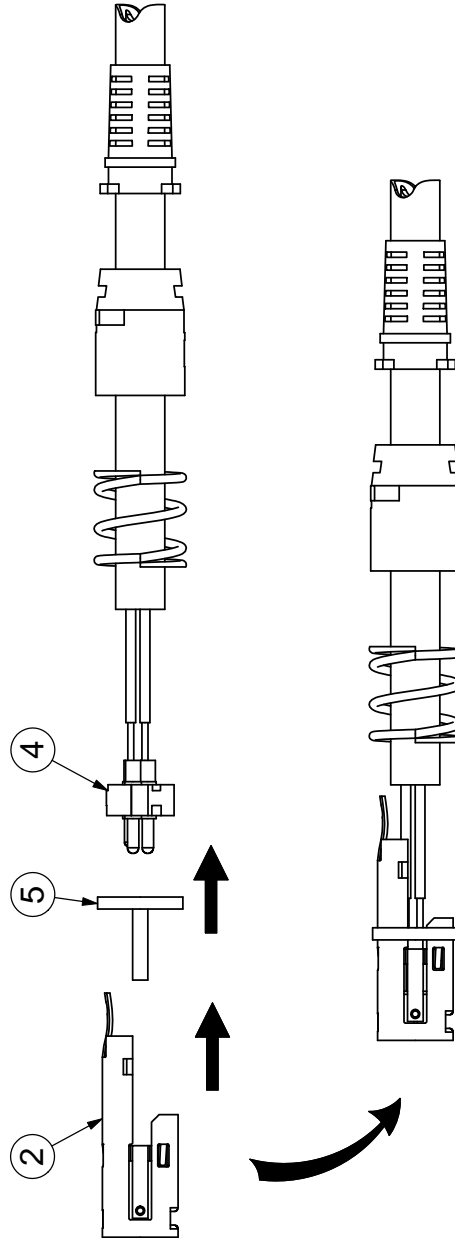

TITLE: 3-PIN POWER DIN PLUG	REV: A
PART NO: PDP-30	UNITS: MM [INCHES]
DRAWN BY: ZRJ	APPROVED BY:
	SCALE: 1:1

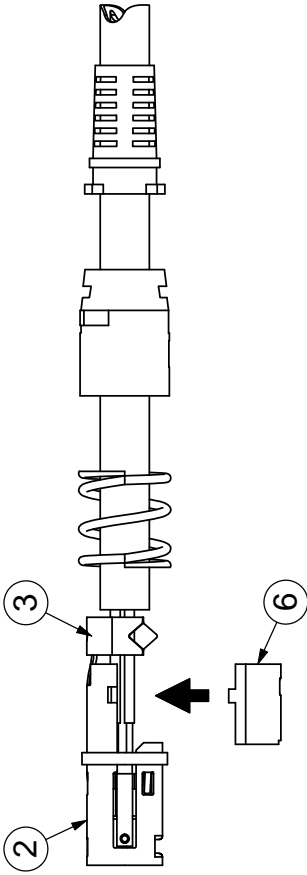

**STEP 4**  
crimp the clamp (3)  
onto wires, assemble  
metal cover (6) onto  
metal sleeve (2)

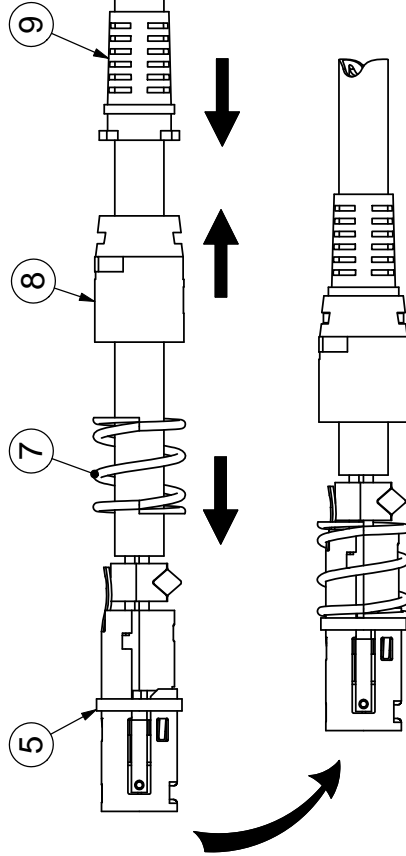

**STEP 5**  
push spring (7) up  
to plastic ring (5),  
assemble inner hood (8)  
and strain relief (9)  
together

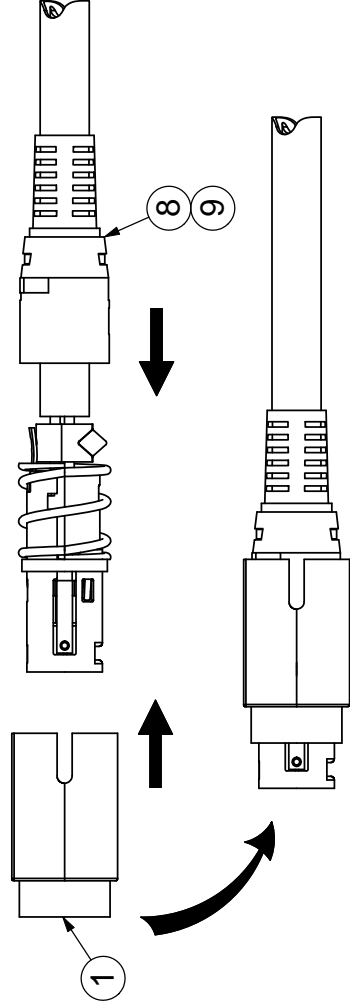

**STEP 6**  
push outer hood (1)  
and inner hood/  
strain relief (8,9)  
together

TITLE: 3-PIN POWER DIN PLUG	REV: A
PART NO: PDP-30	UNITS: MM [INCHES]
DRAWN BY: ZRJ	APPROVED BY:
	SCALE: 1:1