

| REV. | DESCRIPTION                            | DATE      |
|------|--|-----------|
| A    | NEW DRAWING                            | 7/22/2008 |
| B    | multiple part updates                  | 7/30/2010 |
| C    | mechanical change to the bracket shape | 1/23/2012 |

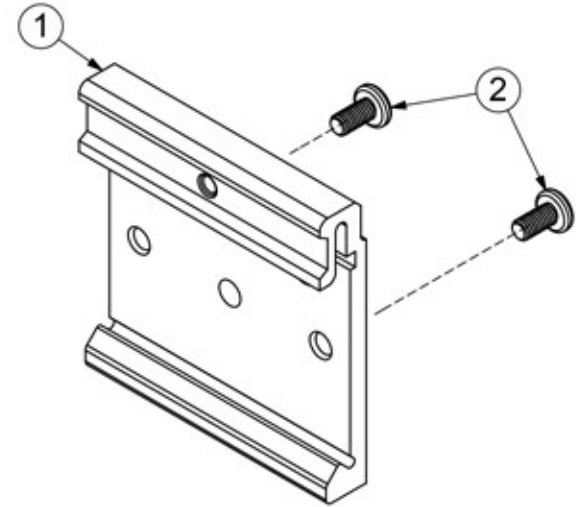
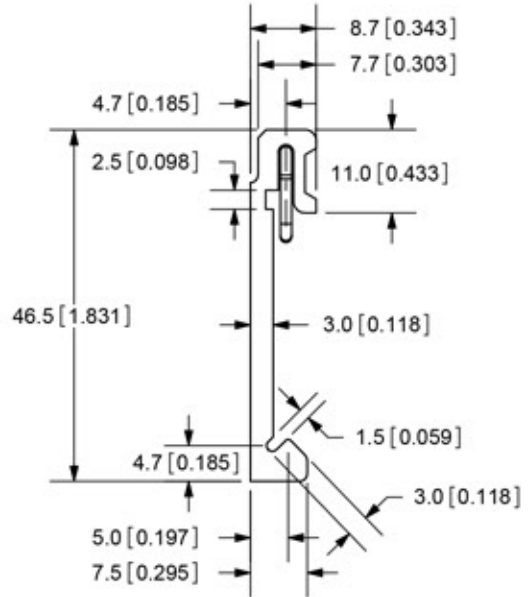
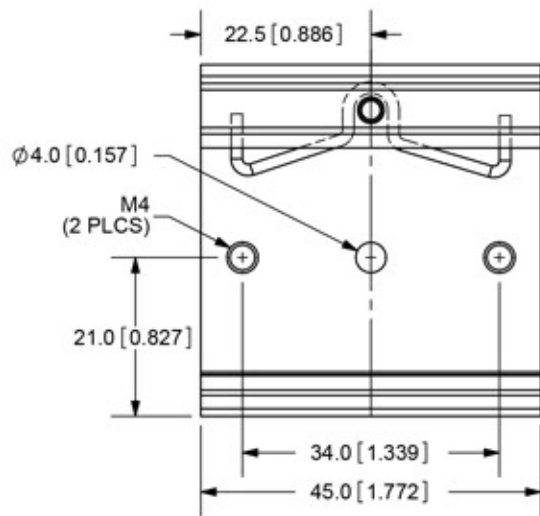

20050 SW 112th Ave.  
Tualatin, OR 97062  
Phone: 503-612-2300  
800-275-4899  
Fax: 503-612-2383  
Website: www.cui.com

|                                  |              |                    |
|----------------------------------|--------------|--------------------|
| TITLE: DIN RAIL MOUNTING BRACKET |              | REV: C             |
| PART NO: STK-DIN                 |              | UNITS: MM [INCHES] |
| DRAWN BY: ZRJ                    | APPROVED BY: | SCALE: 1:1         |

| ITEM | DESCRIPTION | QUANTITY |
|------|-------------|----------|
| 1    | VDRP-03     | 1        |
| 2    | M4X4 SCREWS | 2        |

PC FILE NAME:  
**STK-DIN**

COPYRIGHT 2012 BY CUI INC.

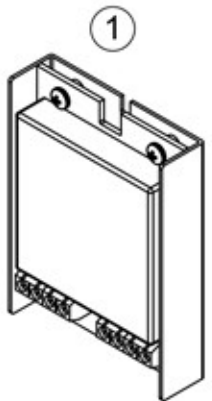

V-INFINITY CHASSIS  
MOUNT CONVERTER  
QTY: 1  
(sold separately)



VDRP-03  
QTY: 1



M4X4  
QTY: 2

**STEP 1**

REMOVE PCB ASSEMBLY FROM V-INFINITY CHASSIS MOUNT  
CONVERTER U-FRAME BY LOOSENING THREE M3X6 SCREWS

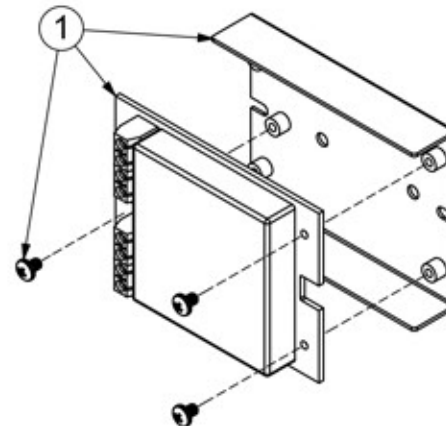

**STEP 2**

ATTACH VDRP-03 TO V-INFINITY CHASSIS MOUNT  
CONVERTER U-FRAME USING TWO M4X4 SCREWS

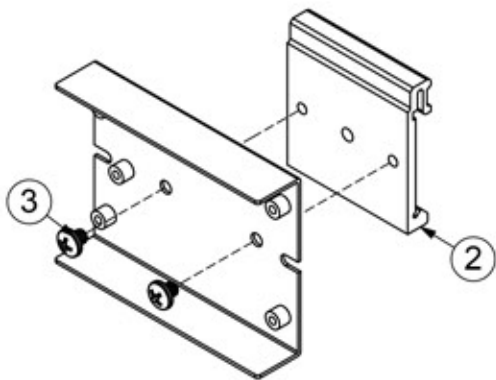

**STEP 3**

REATTACH PCB ASSEMBLY TO U-FRAME OF V-INFINITY  
CHASSIS MOUNT CONVERTER USING THREE M3X6 SCREWS

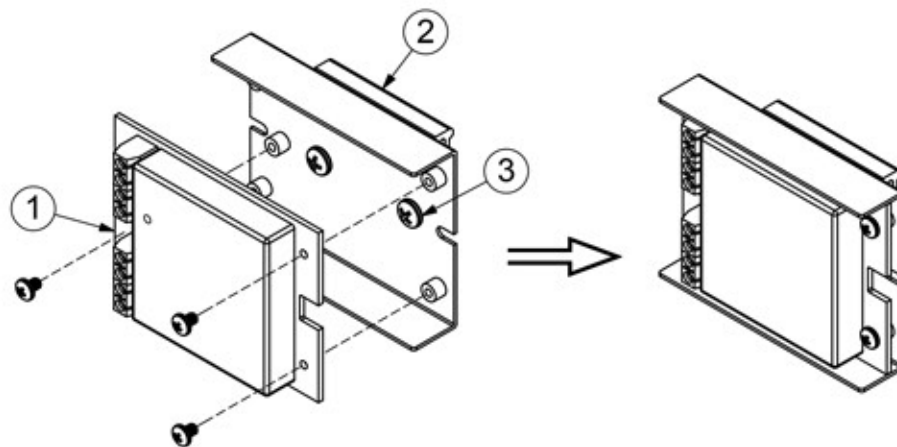

|   |                    |            |
|---|--------------------|------------|
| TITLE: DIN RAIL MOUNTING BRACKET<br>ASSEMBLY INSTRUCTIONS |                    | REV: C     |
| PART NO: STK-DIN  | UNITS: MM [INCHES] |            |
| DRAWN BY: ZRJ   | APPROVED BY:       | SCALE: 1:2 |