



Part No: GA0451

Date: 9/28/2006

Unit: mm

Description: speaker

Page No: 1 of 2



**Specifications**

|                      |  |   |
|----------------------|--|---|
| Nominal Size         | 45 mm (1.75 in)                        | (See attached drawing)                        |
| Impedance            | 8 Ohm $\pm$ 15%                        | at 800 Hz 1 V                                 |
| Resonant frequency   | 500 Hz $\pm$ 100 Hz                    | at 1 V  |
| Sound pressure level | 80 dB/w $\pm$ 3 dB                     | 0.2 w 50 cm ave. at 0.8K, 1.0K, 1.3K, 1.6K Hz |
| Response             | Fo Hz ~9 KHz max 10 dB                 |   |
| Input power          | Nominal 0.2 W                          | Handling capacity 0.5 W                       |
| Operation            | must be normal at program source 0.2 W |   |
| Buzz, rattle, etc.   | must be normal at sine wave 1.26 V     |   |
| Magnet               | Size: 13 x 10 mm                       |   |
| Load test            | White noise 0.2 W                      | for 5 hours                                   |
| Heat test            | 70 $\pm$ 2° C                          | 20-50% R.H. 5 hours                           |
| Humidity test        | 40 $\pm$ 2° C                          | 90-95% R.H. 5 hours                           |

**Frequency Response Curve**

|                       |            |
|-----------------------|------------|
| Potentiometer range   | 50 dB      |
| Rectifier             | RMS        |
| Lower limit frequency | 20 Hz      |
| Wr. speed             | 100 mm/sec |

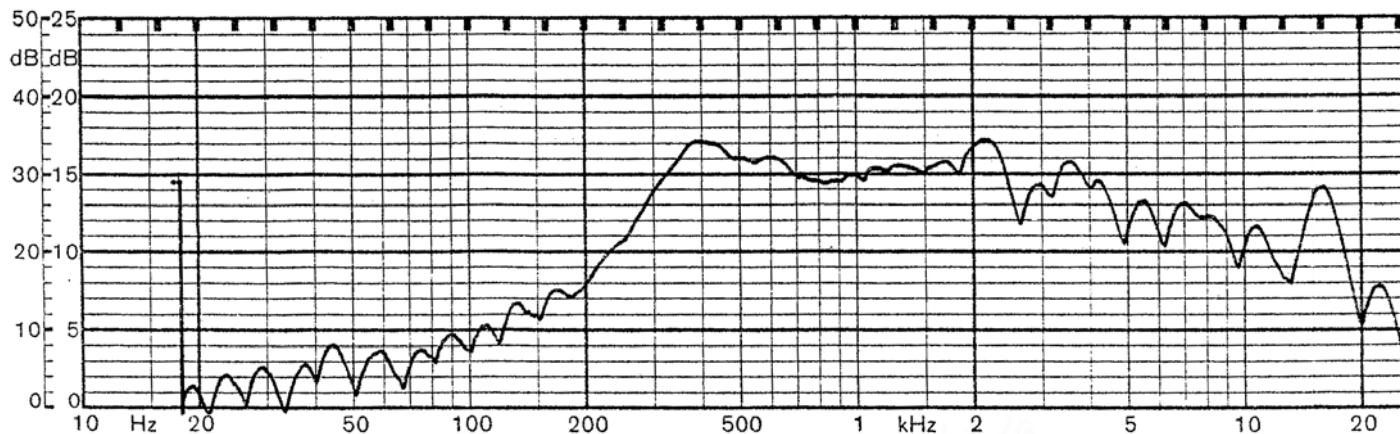

Zero level 50 dB

|      |             |           |
|------|-------------|-----------|
| REV. | DESCRIPTION | DATE      |
| A    | NEW DRAWING | 9/15/2006 |

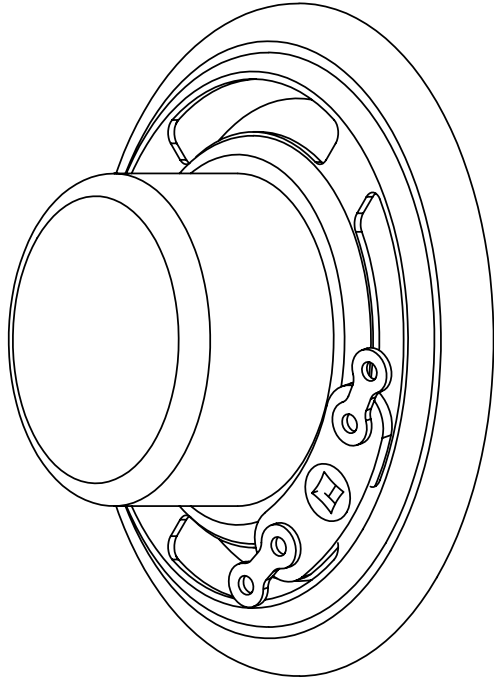
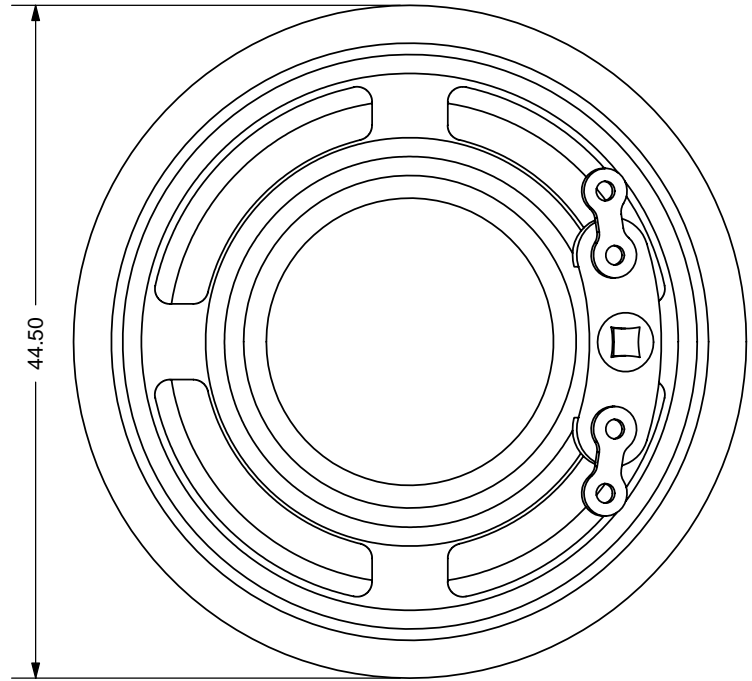
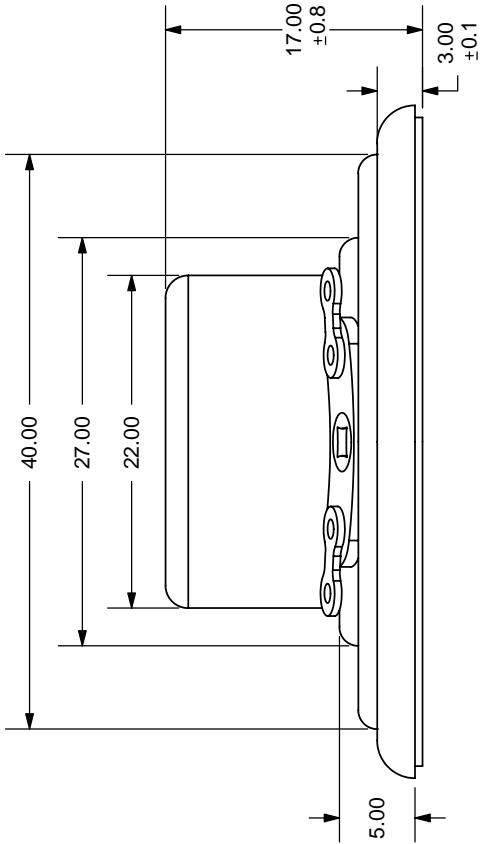

TOLERANCE:  
±0.5mm UNLESS OTHERWISE  
SPECIFIED



**CUI INC**

20050 SW 112th Ave.  
Tualatin, OR 97062  
Phone: 503-643-4899  
800-275-4899  
Fax: 503-372-1266  
Website: www.cui.com

|   |                    |
|---|--------------------|
| TITLE: Round frame paper cone - alnico magnet | REV: A             |
| PART NO: GA0451                               | UNITS: MM [INCHES] |
| DRAWN BY: ZRJ                                 | APPROVED BY:       |
|   | SCALE: 2:1         |