



PART NUMBER: NSC-XXXX-2MD-RES

DESCRIPTION: incremental shaft type encoder

ELECTRICAL SPECIFICATIONS

output waveform	square wave
output signals	A, B, Z phase, inverse A, B, Z phase
current consumption	≤150 mA
frequency response	≤150 kHz
supply voltage	5 V dc ± 5%
sink current	≤20 mA
output voltage	“H” 2.5 V min. “L” 0.5 V max.
output resolution (ppr)	1024, 1500
waveform rise/fall time	200 ns max.

MECHANICAL SPECIFICATIONS

max shaft load, radial:	1.0 kgf
axial:	0.5 kgf
starting torque	10 gf·cm max.
angular acceleration	1x10 ⁵ rad/s ²
moment of inertia	2.0 g·cm ²
max rotational speed	6000 RPM
shock resistance	50 G, 11 ms, 3 times each on XYZ
vibration proof	10 ~ 50 Hz, double amplitude 1.5 mm, 2 hours
rotational life	1x10 ⁸ rpm·hrs

ENVIRONMENTAL SPECIFICATIONS

operating temp	-10° to +60° C
storage temp	-30° to +80° C
humidity	RH 85% max., non-collecting

ELECTRICAL CONNECTIONS

2MD

Color of Lead Wire	Description	Color of Lead Wire	Description
Red	Power Source	White	Signal B ₋
Black	0V Common	Gray	Signal B ₊
Green	Signal A ₋	Yellow	Signal Z ₋
Blue	Signal A ₊	Orange	Signal Z ₊
Shielding Braid	NC		

PART NUMBER: NSC-XXXX-2MD-RES

DESCRIPTION: incremental shaft type encoder

ORDERING INSTRUCTIONS

NSC-XXXX-2MD-RES

Resolution:
1024 = 1024 PPR
15 = 1500 PPR

CIRCUIT CONNECTIONS

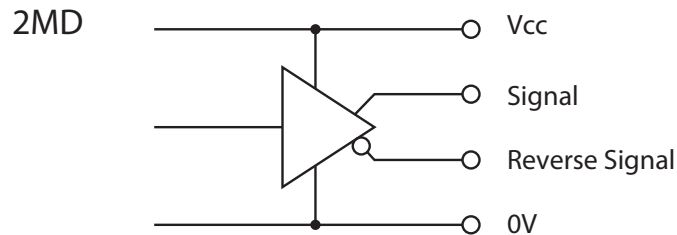

OUTPUT WAVEFORM

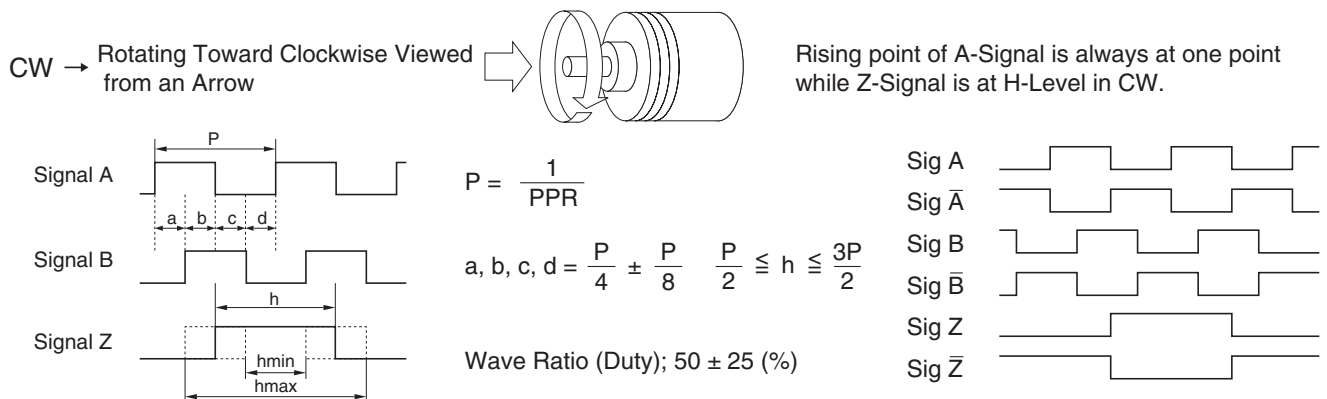

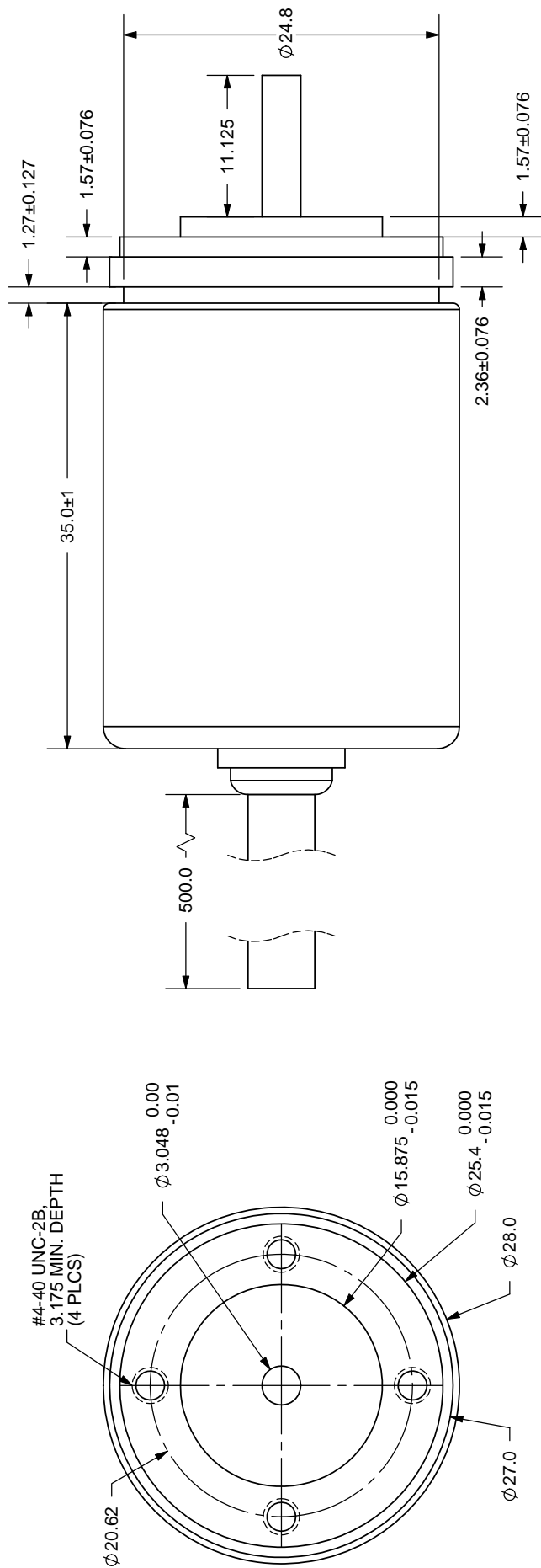

TOLERANCE:
±0.3mm UNLESS OTHERWISE
SPECIFIED



CUI INC

20050 SW 112th Ave.
Tualatin, OR 97062
Phone: 503-612-2300
800-275-4899
Fax: 503-612-2383
Website: www.cui.com

TITLE: Incremental Encoder	REV: A
PART NO: NSC-XXXX-2MD-RES	UNITS: MM [INCHES]
DRAWN BY: JMS	APPROVED BY:
	SCALE: 2:1